

Figure A

Ductmate Industries provides for an access door design that is both effective and easy to install. The access door fire barrier system consists of the Ductmate ULTIMATE Door and Ultimate Door II with UL Insulation Kit (Part #: ULINSULKIT) and the UL Outer plate (Part #: OP_ULBI or OP_ULS4 Must Insert Required Size). Both Parts can be bought from an authorized Ductmate distributor.

Depending on the wrap system being used, and the required fire rating, two or three layers of Duct Wrap will need to be cut for the installation of the fire barrier system. (Different suppliers of duct wrap require two or three layers covering the door. Please check with your duct wrap supplier).

When installing the system, the wrap around the door assembly should be cut with a sharp knife to allow for a 3" perimeter around the door opening. For instance, a door with a 10" X 6" opening has the first layer of Duct Wrap cut to a size of 13" x 9". The second layer of Duct Wrap should be cut to a size of 16" X 12". Two or Three pads of Duct Wrap are cut to accommodate the stepped joints in the door assembly. In the 10" X 6" door opening example, the first step joint at 13" X 9" would use a pad that has been cut to 13.5" x 9.5". This slight over sizing allows for a very tight seal between the butt joints of the Duct Wrap. The second Duct Wrap pad would have a dimension of 16.5" X 12.5". In this example, the final pad has a dimension of 19" X 15".

Each of these pads is impaled over the threaded studs. In the first two layers, care should be taken to ensure that the joints between the pads and Duct Wrap are equally tight. The third pad (if required) is placed over the second layer of Duct Wrap and overlaps the edges by 1.5" around the perimeter. The exposed edges of the final cut layer must be covered with 2-mil aluminum foil tape. In the above example the outer plate (Part # OP_ULBI or OP_ULS4 Must Insert Required Size) would be cut to 16" X 12" with holes placed in the plate to coincide with the inner plate. The outer plate is pushed over the threaded rods and tightened to firmly compress the Duct Wrap pads over the inner plate and the third pad against the outer jacket of the Duct Wrap system. A sign is applied on the outer plate indicating "Access Panel - Do Not Obstruct".

Care should be taken in construction to allow the cleanout crews to easily identify where the opening is located beneath the Duct Wrap layers. The cleanout crew will be required to remove the two layers that cover the openings, do the necessary cleaning, reinstall the access door plate and then replacing the layers previously removed.

The instructions are only a guidance for installing the duct wrap. The contractor or installer should check with the duct wrap manufacturer and the building official to approve the insulation of the duct wrap as to their specifications.

ULTIMATE DOOR™ & ULTIMATE DOOR II™ WELD ON

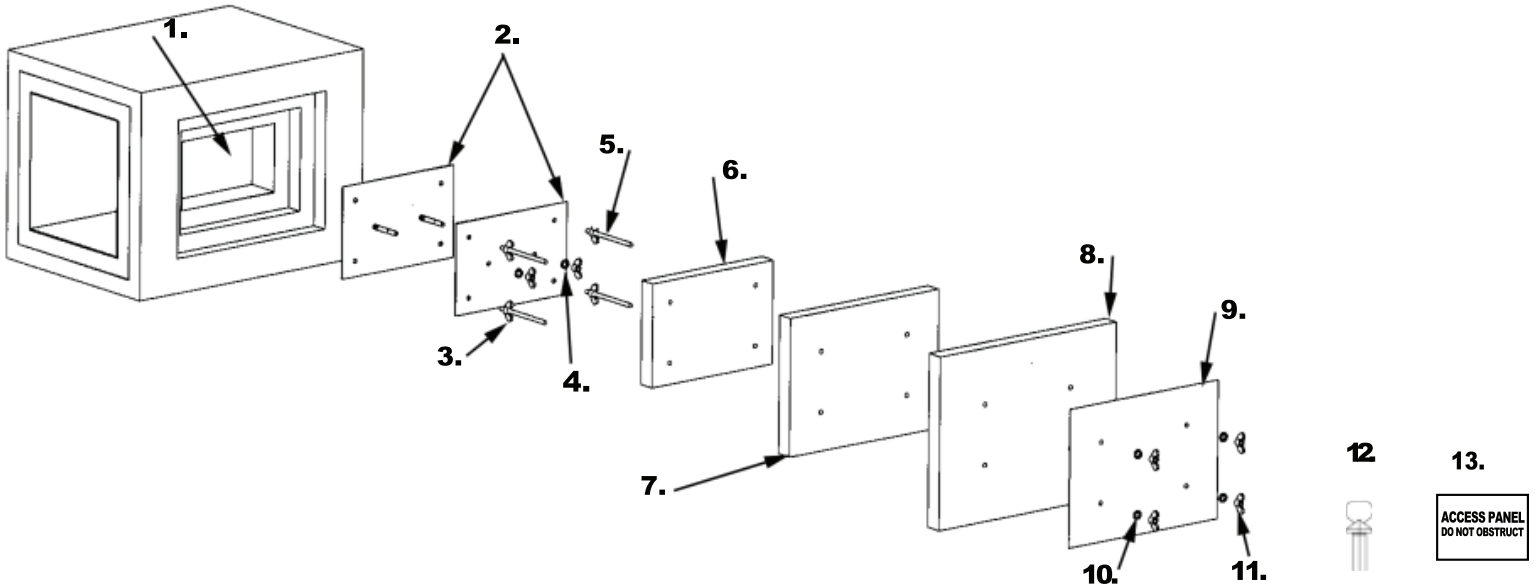

Duct Wrap System

(Ductmate does not supply duct wrap)

1. Duct Opening
2. Ductmate ULTIMATE Grease Duct Access Door
3. Wing Nuts
4. Washers
5. Extended Insulation Studs
6. One Layer 1½" Fire Wrap
7. One Layer 1½" Fire Wrap With 1½" Overlap
8. One Layer 1½" Fire Wrap With 1½" Overlap
9. Outer Access Door Plate (16 Ga Minimum)
10. Washers
11. Wing Nuts
12. Thumb Bolts
13. Identification Sign

DUCTMATE INDUSTRIES ULTIMATE/ULTIMATE II GREASE DUCT ACCESS DOORS

For Use With Duct Warp Systems



DUCTMATE® Industries, Inc.

MONONGAHELA, PA
1502 Industrial Drive
Monongahela, PA 15063
724-258-0500

LODI, CA
810 S Cluff Avenue
Lodi, CA 95240
209-333-4680

WAGONER, OK
300 SE 15th Street
Wagoner, OK 74467
918-485-1700

1-800-245-3188 • www.ductmate.com