

# HURRICANE AIR BRACE™

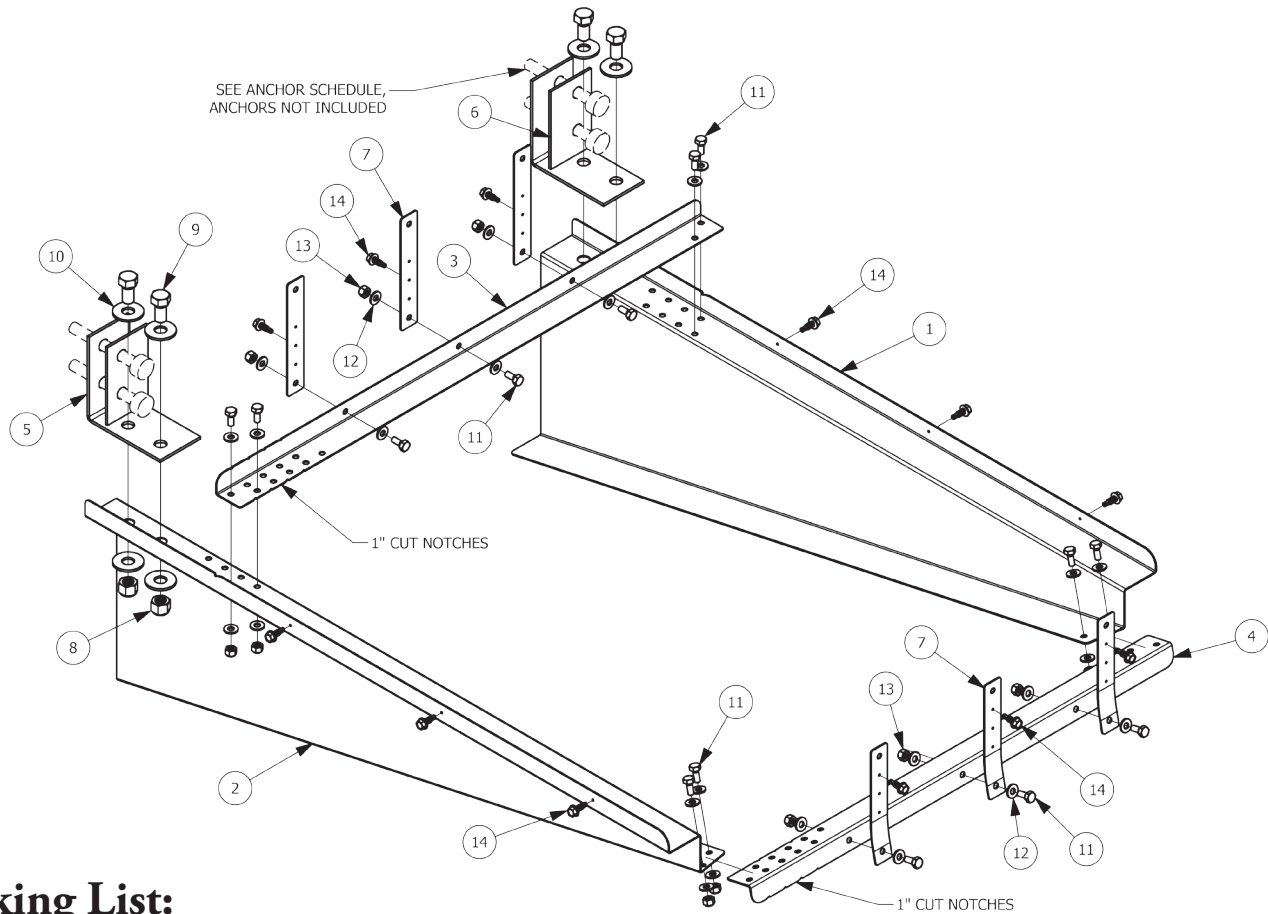

## Packing List:

1. (1) Side Bracket, Right
2. (1) Side Bracket, Left
3. (1) Top Cross Brace
4. (1) Front Cross Brace
5. (2) Mounting Bracket
6. (2) Support Bracket (For 45" and 55" Air Brace Only)
7. (6) Strap
8. (4) 1/2"-13 Lock Nut
9. (4) 1/2"-13, 1" Long Bolt
10. (8) 1/2" Washer
11. (14) 1/4"-20, 5/8" Long Bolt
12. (28) 1/4" Washer
13. (14) 1/4"-20 Lock Nut
14. (12) #14 Tek Screw

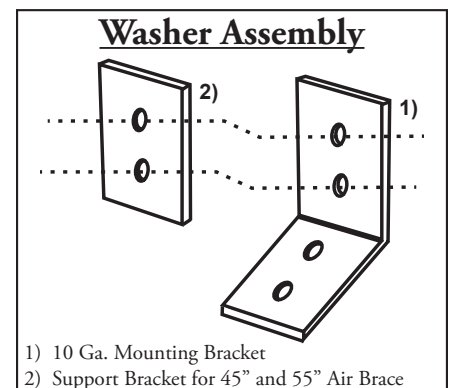

**Engineer:**  
Engineering Express  
Frank L. Bennardo, P.E.  
PE0046549  
160 SW 12th Avenue, #106  
Deerfield Beach, FL 33442  
P: 954-354-0660  
F: 954-354-0443

**Ductmate Industries, Inc.**  
210 Fifth Street  
Charleroi, PA 15022

TITLE  
**Hurricane Air Brace Installation Instructions - Coastal and Inland Revised for 2014 FBC**

# HURRICANE AIR BRACE™

## Assembly Directions



1. Lay out all parts as shown in the diagram (on reverse page). Measure the width of your A/C unit to determine the length of the top cross brace.
2. If necessary, trim top cross brace and front cross brace per 1" cut notches. Trim front cross brace 4" shorter than top cross brace.
3. Attach the top cross brace by using (1) set of bolts, washers, and self-locking nuts on each side. Attach the front cross brace (in the bottom ledge) by using (1) set of bolts, washers, and self-locking nuts on each side.
4. Secure cross brace with a second bolt, diagonally from each other, in each side.
5. Attach the 10 gauge mount brackets with (2) sets of bolts, washers, and self-locking nuts on each bracket side. (Use support bracket for 45" and 55" Air Brace only.)
6. Mount brackets to wall material per the Anchor Schedule. (No hardware is supplied for mounting the bracket to any wall material.)
7. Add vibration pads as specified by the A/C manufacturer.

**Note: The enclosed strapping is to be used in areas requiring hurricane restraints.**

8. If strapping is needed for inland or coastal areas, follow these additional instructions:
9. Attach 1" x 16 Ga. Galvanized hurricane straps to both cross braces with a set of bolts, washers, and self-locking nuts. Attach other end of hurricane strap to bottom side of A/C unit with #14 Galv. self-tapping Tek screws, 3/4" long (1 Tek screw & 1 bolt set per strap, 6 straps total). Hurricane straps should have zero slack.

| Air Conditioner Platform Reactions Table |                  |                                |                                |
|--|------------------|--------------------------------|--------------------------------|
| Inland Wall Material                     | Allowable Weight | Allowable Elevation at 140 MPH | Allowable Elevation at 180 MPH |
| Concrete Block/Brick                     | 375 lbs          | 45'                            | 30'                            |
| Concrete                                 | 425 lbs          | 45'                            | 30'                            |
| Steel Stud                               | 375 lbs          | 30'                            | 30'                            |
| Wood Stud                                | 375 lbs          | 30'                            | 30'                            |
| Coastal Wall Material                    | Allowable Weight | Allowable Elevation at 180 MPH | Allowable Elevation at 186 MPH |
| Concrete Block/Brick                     | 375 lbs          | 40'                            | 30'                            |
| Concrete                                 | 425 lbs          | 40'                            | 30'                            |
| Steel Stud                               | 375 lbs          | 30'                            | 30'                            |
| Wood Stud                                | 375 lbs          | 30'                            | 30'                            |

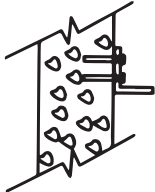
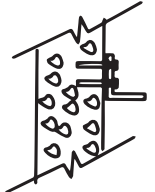
## Anchor Schedule

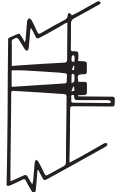
| Concrete  | Concrete Block / Brick  | Steel Stud   | Wood Stud  |
|---|---|--|--|
|                  |    |  |   |
| <b>Fasteners:</b><br>(2) 1/2" x 3 3/4" Galv. Std. Hilti Kwik Bolt or equivalent<br>2 3/4" Min Embed | <b>Fasteners:</b><br>(2) 1/2" x 3 3/4" Galv. Std. Hilti Kwik Bolt or equivalent<br>2 3/4" Min Embed<br>(note: ribs only every 4" in cmu-use 5/8" x 10" Galv. Hex bolt where no rib) | <b>Fasteners:</b><br>(2) 5/16" x 1 1/4" TEC screw with self-locking washer.          | <b>Fasteners:</b><br>(2) 1/2" x 3 3/4" Hex head Lag screw with S.L. washer. 2 3/4" Min. Embed (may require extra 2x4 for behind 1 support angle) |



Contact your local distributor for an official pressed-seal document.